

INSTALLATION INSTRUCTIONS
EZ Install Lift Kit:
for Polaris Sportsman[®]

This product is designed, and manufactured, to gain additional ground clearance on utility vehicles and to be used at slower speeds on level terrains. Installation of this product increases angle of Axles which may result in frequency of required maintenance and parts wear. It is recommend that wider Tires or Wheel Spacers be used, in conjunction, with this kit to improve stability.

Item	Description
A	Front Adapter x 2

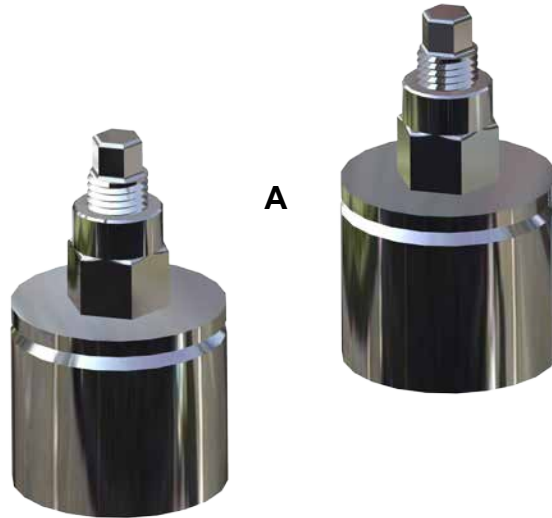

(kit contents continue on following page)

Liability Statement

SuperATV's[®] products are designed to best fit user's ATV/UTV under stock conditions. Adding, modifying, or fabricating any factory or aftermarket parts will void any warranty provided by SuperATV[®] and is not recommended. SuperATV's[®] products could interfere with other aftermarket accessories. If user has aftermarket products on machine, contact SuperATV[®] to verify that they will work together.

Although SuperATV[®] has thousands of satisfied customers, user should be aware that installing lift kits, long travel, or suspension kits, tires, etc. will change the ride of machine and may increase maintenance and part wear. Operating any off-road machine while, or after, consuming alcohol and/or drugs increases risk of bodily harm or death. No warranty or representation is made as to this product's ability to protect user from severe injury or death. SuperATV[®] urges operators and occupants to wear a helmet and appropriate riding gear at all times.

By purchasing and installing SuperATV[®] products, user agrees that should damages occur, SuperATV[®] will not be held responsible for loss of time, use, labor fees, replacement parts, or freight charges. SuperATV[®], nor any 3rd party, will not be held responsible for any direct, indirect, incidental, special, or consequential damages that result from any product purchased from SuperATV[®]. The total liability of seller to user for all damages, losses, and causes of action, if any, shall not exceed the total purchase price paid for the product that gave rise to the claim.

SuperATV[®] will warranty only parts provided by SuperATV[®]. Any damage or problems with OEM housings, bearings, seals, or other manufacturers' products will not be covered by SuperATV[®]. SuperATV[®] parts and products are not warranted if item was not installed properly, misused, or modified.

Installing, adding, modifying, or fabricating any factory or aftermarket product to your ATV/UTV may violate certain local, state, and federal laws. Be advised that laws vary depending on town, city, county, state, etc. Use of certain products on public streets, roads, or highways may be in violation law. The Buyer is solely and exclusively legally and personally responsible for any violation of the law by the installation or use of the product. You must abide by all local, state, and federal laws, including but not limited to vehicle safety, traffic laws, and ordinances. It is your responsibility to know the laws and how they apply to you.

The Buyer is responsible to fully understand the capability and limitations of his/her vehicle according to manufacturer specifications, warnings and instructions and agrees to hold SuperATV[®] harmless from any damage resulting from failure to adhere to such specifications, warnings and/ or instructions. The Buyer is also responsible to obey all applicable federal, state, and local laws and ordinances when operating his/her vehicle while using this product, and the Buyer agrees to hold SuperATV[®] harmless from any violation thereof.

Need help with your installation?



sales@superatv.com



www.superatv.com



1-855-743-3427



8:00am - 8:00pm EST M-Th
 8:00am - 7:00pm EST Friday
 9:00am - 2:00pm EST Saturday

Read instructions and view illustrations before beginning.

*Thank You
 For Choosing*



Item	Description
C	Rear Bracket, Large x 2
D	Rear Bracket, Small x 2

(kit contents continued)

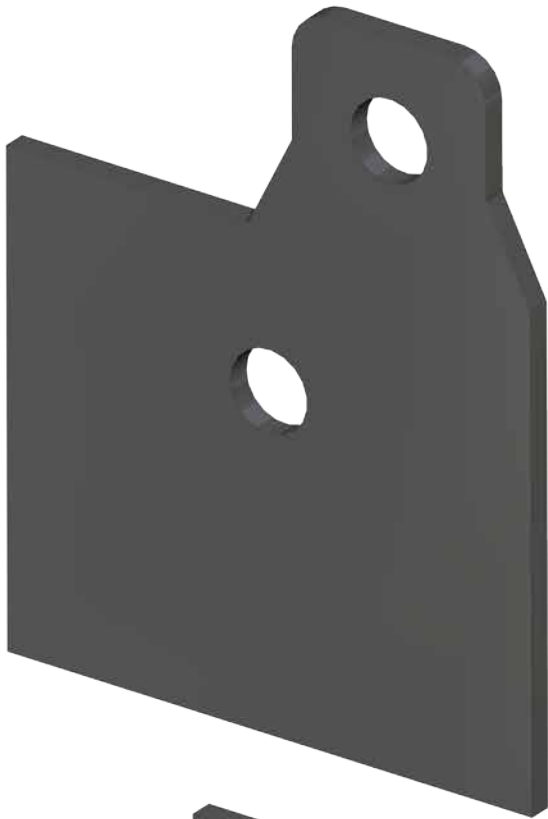

C

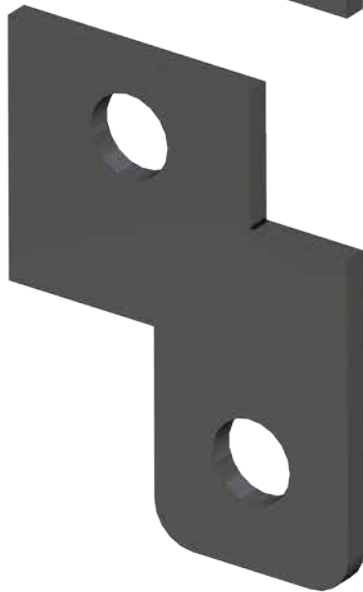

D

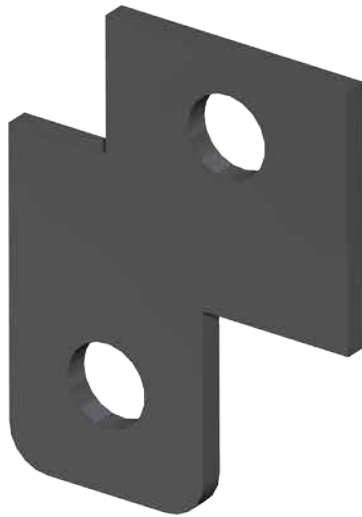

Do not tighten hardware completely unless noted. Keep all stock hardware removed from machine.

Front:

- Raise front of machine off ground, secure on jack stands, and remove Wheels, Front Box, and Rack if applicable. **Do not raise too high, as Axles on some models may pull from Lower CV Joint.**
- Remove Lock Nut, Washer, and Plastic Bearing from top of Strut Assembly. Pull top of Strut from Frame.
- Screw Front Adapter (A) onto Strut and tighten.
- Reinstall Plastic Bearing and place Strut Assembly in Frame using new Front Adapter Screw and tighten.
- Reinstall Top Washer and Lock Nut.
- Repeat steps for opposite side.
- Reinstall necessary components and tighten all hardware completely.

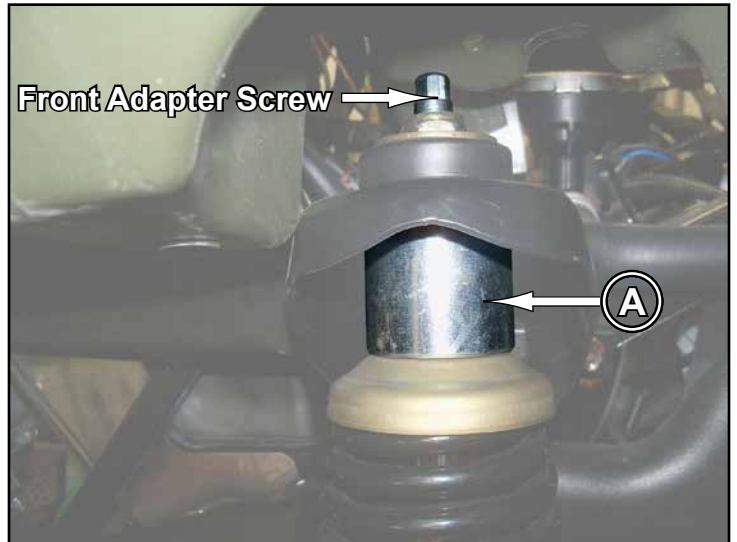
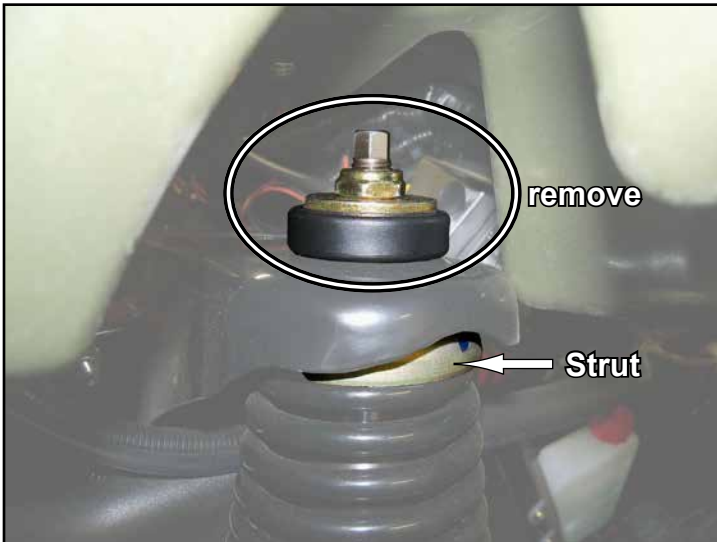

Do not tighten hardware completely unless noted. Keep all stock hardware removed from machine.

Rear:

- Raise rear of machine off ground and secure with jack stands and remove Wheels.
- Remove lower Shocks from A-Arms.
- Install Rear Brackets (C)(D) to Lower A-Arms with hardware shown.
- Rear Brackets, Large (C) install to **inside** of Shock Bracket.
- Rear Brackets, Small (D) mounts to **outside** of Shock Bracket.
- Reinstall Shocks to Rear Brackets (C)(D) with stock hardware.

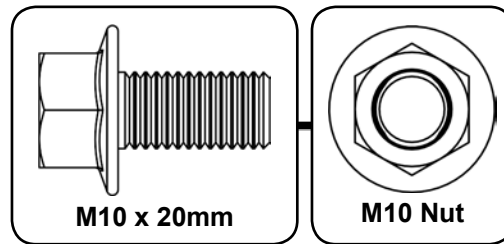
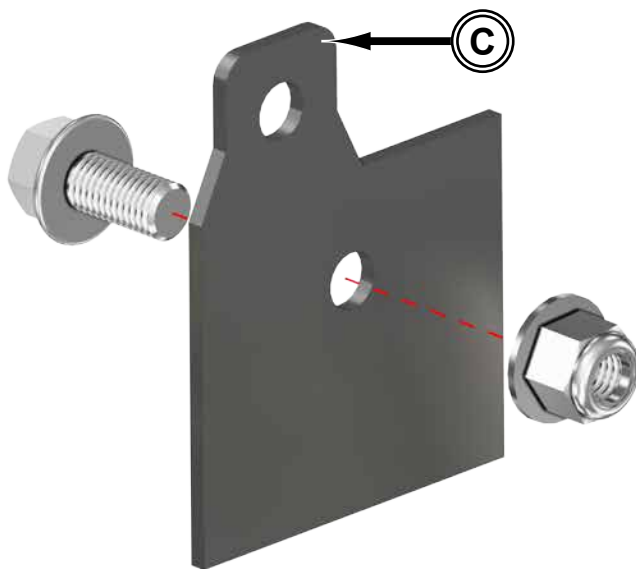
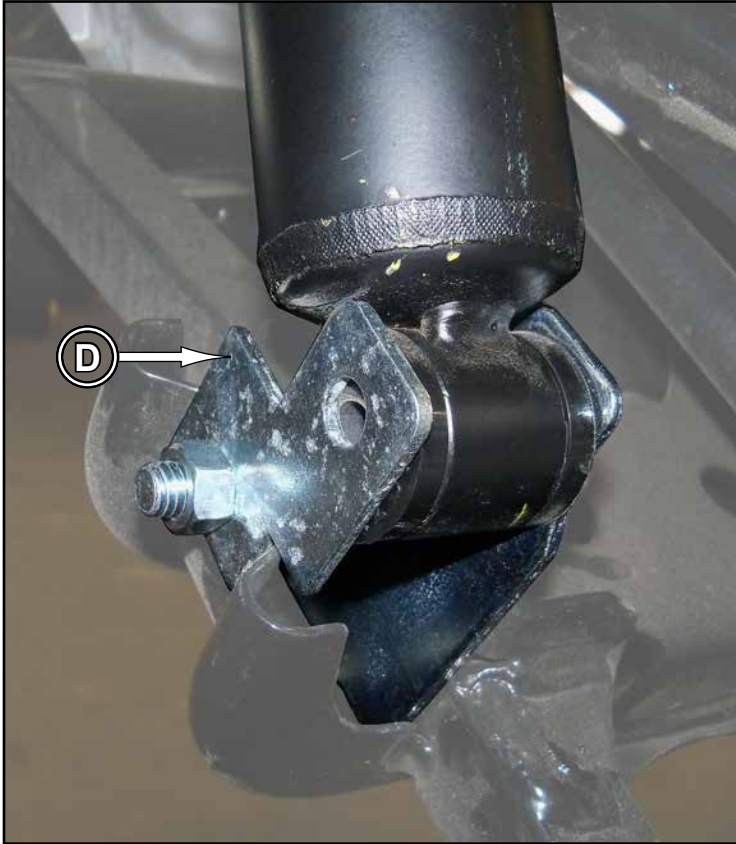

2 each

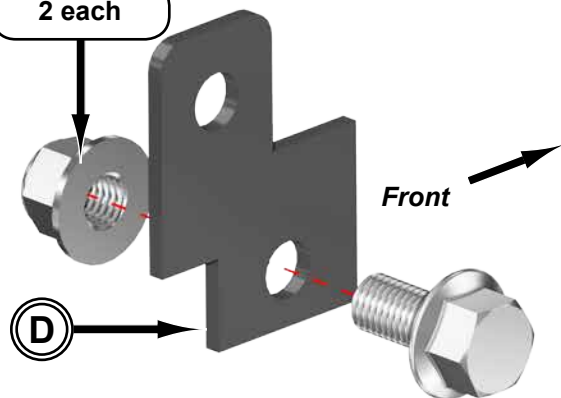

(Right)

Rear continued:

- Remove top (2) bolts from each side of Torsion Bar.
- Install Hex Spacers on top of existing Spacers. Install hardware shown through assembly. Rubber Bushings must go back to original positions.
- Tighten all hardware completely and reinstall Wheels.

